

vtech[®]

Parent's Guide

4-in-1 Stroll & Grow Tek Trike™

9 Mos
to
6 Yrs



91-003399-004 (US) (CN)

INTRODUCTION

Thank you for purchasing the **VTech® 4-in-1 Stroll & Grow Tek Trike™**.

Through interactive riding, your child can pretend to role-play and enjoy cheerful melodies and sing-along songs. With the interactive panel and four trike stage settings, your child will enjoy endless riding fun!

- | | |
|--------------------------|---------------------|
| ① LED DISPLAY | ⑧ MUSIC STOP BUTTON |
| ② LEFT/RIGHT LED | ⑨ GEAR SHIFT |
| ③ MELODY BUTTON | ⑩ ON/OFF BUTTON |
| ④ ROLE-PLAY BUTTONS | ⑪ LOCATION BUTTONS |
| ⑤ SING-ALONG SONG BUTTON | ⑫ HORN BUTTON |
| ⑥ IGNITION SWITCH | ⑬ MODE SELECTOR |
| ⑦ VOLUME BUTTON | |

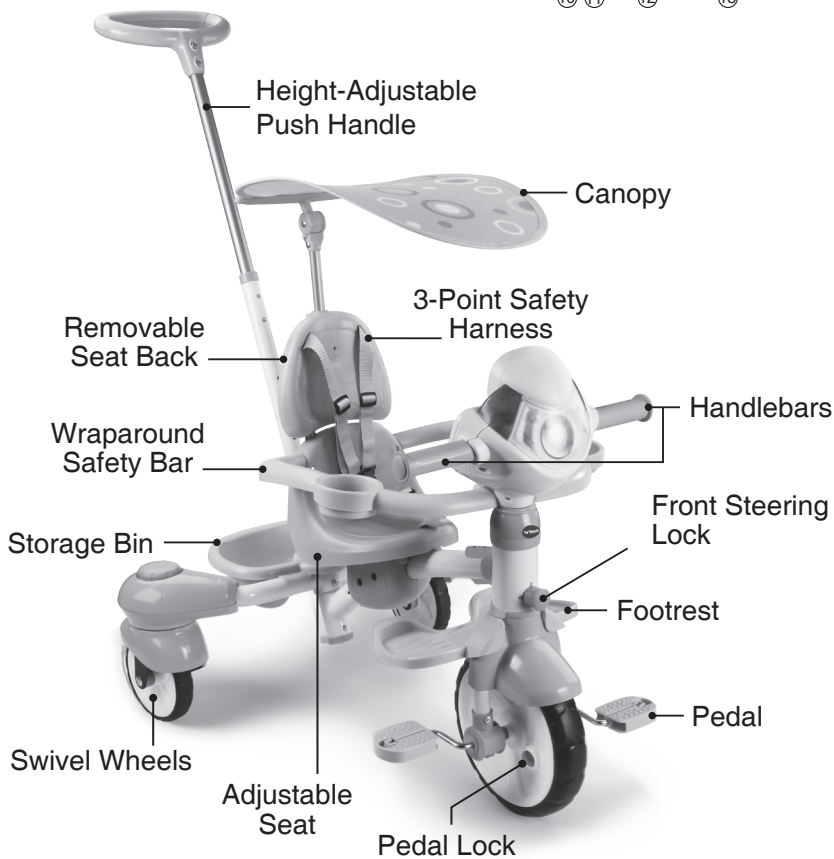
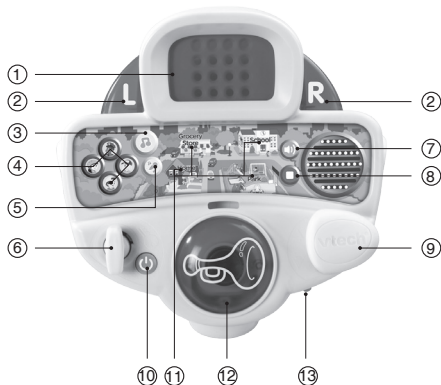

SAFETY WARNINGS

WARNING:

All packing materials such as tape, plastic sheets, packaging locks, removable tags, cable ties and packaging screws are not part of this toy, and should be discarded for your child's safety.

NOTE: Please keep this parent's guide as it contains important information.

ATTENTION:

Pour la sécurité de votre enfant, débarrassez-vous de tous les produits d'emballage tels que rubans adhésifs, feuilles de plastique, attaches, étiquettes et vis d'emballage. Ils ne font pas partie du jouet.

ATTENTION: Il est conseillé de conserver ce guide des parents car il comporte des informations importantes.



Fiber adhesive tape and paper board are not part of this toy, and should be discarded for your child's safety.

Le ruban adhésif et les petits morceaux de carton ne font pas partie du jouet. Pour la sécurité de votre enfant, jetez-les.

⚠ WARNING:

- **TO AVOID SERIOUS INJURY:** Continuous adult supervision required; never use near motor vehicles; never use near streets, swimming pools, hills, steps, or sloped driveways; Always wear shoes when using the tricycle. Never allow more than one rider.
- It is recommended that rider should always wear a properly fitted helmet that complies with U.S. Consumer Product Safety Commission (CPSC) Standard 16 CFR 1203.
- Maximum Weight Capacity: 56 lbs (25.4 kg).
- Maximum permissible load of storage bin is 6.6 lb (3 kg). Excessive weight may cause hazardous or unstable conditions.
- Transporting a child in the tricycle up or down stairs may lead to falls and possible serious injury. Height-adjustable push handle is not intended to support the weight of the tricycle and the rider. Child must be removed from tricycle before transporting up or down stairs.
- Keep away from fire.

⚠ AVERTISSEMENT:

- **AFIN D'ÉVITER DES BLESSURES GRAVES, NE JAMAIS LAISSER UN ENFANT JOUER SANS LA SURVEILLANCE D'UN ADULTE.** Ne pas utiliser sur la voie publique ou près de véhicules motorisés. Ne pas utiliser à proximité d'une piscine, sur des voies en pente ou en côte ainsi que sur des escaliers. Il convient de porter un équipement de protection ainsi que des chaussures fermées. Ne pas monter à deux ou plus sur le tricycle (un seul utilisateur à la fois).
- IL est recommandé que l'enfant porte toujours un casque de protection bien ajusté, conforme à la norme 16 CFR 1203 de la Commission américaine de surveillance des produits de consommation (CPSC).
- Poids maximum : 56 lbs (25 kg).
- Charge maximale pour le compartiment arrière : 6.6 lb (3 kg). Une charge supérieure pourrait causer une instabilité ou une situation dangereuse.
- Ne jamais descendre ou monter les escaliers avec un enfant assis sur le tricycle. La canne parentale amovible n'est pas conçue pour supporter le poids du tricycle et de l'enfant dans ces conditions. Faire descendre l'enfant du tricycle avant de monter ou descendre des escaliers.
- Attention ! Tenir loin du feu.

⚠ WARNING:

Adult assembly required. Choking hazard to children under the age of 3 years – contains small parts prior to assembly.

⚠ AVERTISSEMENT:

L'assemblage doit être effectué par un adulte. Le jouet contenant de petites pièces, il existe un risque d'étouffement pour les enfants de moins de 3 ans avant l'assemblage.

DRIFT STAGE: USE WITH CAUTION

When using the 4-in-1 Stroll & Grow Tek Trike™ in drift stage, riders and guardians should use at their own risk and exercise common sense. It is possible to lose control, fall off and/or get into unsafe situations.

Keep an eye out for obstacles and situations that could force you to unexpectedly swerve or lose control. Hold the handlebars at all times. Do not hitch a ride on a vehicle at any time. Avoid riding on uneven or unsafe surfaces. We advise you to ride on solid, flat, level ground. Do not use indoors.

The recommended rider age of 4-6 years for the drift stage is a suggestion. Any rider unable to comfortably fit on the 4-in-1 Stroll & Grow Tek Trike™ in drift stage should not attempt to ride it. Parents should make the decision to allow their child to ride based on the child's skill level and abilities.

Parents: Please review this guide and ensure that all riders understand the warnings and safety guidelines to safely use the 4-in-1 Stroll & Grow Tek Trike™.

STADE 4, MODE « DÉRAPAGES » : PRÉCAUTIONS D'USAGE

Les enfants ne peuvent utiliser le Super tricycle interactif 4 en 1 en mode « dérapages » (stade 4) uniquement sous la surveillance constante d'un adulte.

Il est possible que l'enfant perde le contrôle du tricycle, tombe et/ou se retrouve dans une situation dangereuse.

Soyez toujours attentif à votre environnement et anticipez les situations ou obstacles qui pourraient faire perdre le contrôle du tricycle à votre enfant.

Votre enfant doit tenir les poignées de façon continue et ne doit en aucun cas s'accrocher à un véhicule motorisé. Ne pas jouer avec le tricycle sur des voies non sécurisées ou accidentées. Nous recommandons un usage de ce jouet sur des surfaces planes et dures. Ne pas utiliser en intérieur.

L'âge recommandé de 4 ans minimum pour ce mode est seulement une suggestion, chaque enfant évoluant à son propre rythme. Si l'utilisateur n'est pas capable de tenir assis seul sur le Super tricycle interactif 4 en 1, nous vous recommandons de reporter le passage au stade 4, le mode « dérapages », pour plus tard. Les parents sont les seuls responsables de la décision de laisser leur enfant essayer ou non ce mode, et sont les plus à mêmes de juger leurs capacités psychomotrices.

Note aux parents : merci de lire et bien conserver ce manuel de montage et d'utilisation afin d'utiliser le Super tricycle 4 en 1 en toute sécurité.

GETTING STARTED

BATTERY INSTALLATION

1. Make sure the unit is turned OFF.
2. Use a screwdriver to loosen the screw and open the battery cover.
3. Install 2 new AA size (LR6/AM-3) batteries following the diagram inside the battery box. (The use of new alkaline batteries is recommended for maximum performance.)
4. Replace the battery cover and tighten the screw to secure.

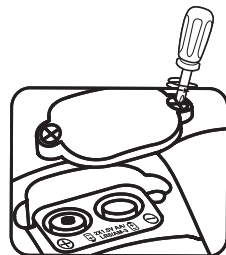

BATTERY NOTICE

- Use new alkaline batteries for maximum performance.
- Use only batteries of the same or equivalent type as recommended.
- Do not mix different types of batteries: alkaline, standard (carbon-zinc) or rechargeable, or new and used batteries.
- Do not use damaged batteries.
- Insert batteries with the correct polarity.
- Do not short-circuit the battery terminals.
- Remove exhausted batteries from the toy.
- Remove batteries during long periods of non-use.
- Do not dispose of batteries in fire.
- Do not charge non-rechargeable batteries.
- Remove rechargeable batteries from the toy before charging (if removable).
- Rechargeable batteries are only to be charged under adult supervision.

INCLUDED IN THIS PACKAGE

- One 4-in-1 Stroll & Grow Tek Trike™
- One parent's guide

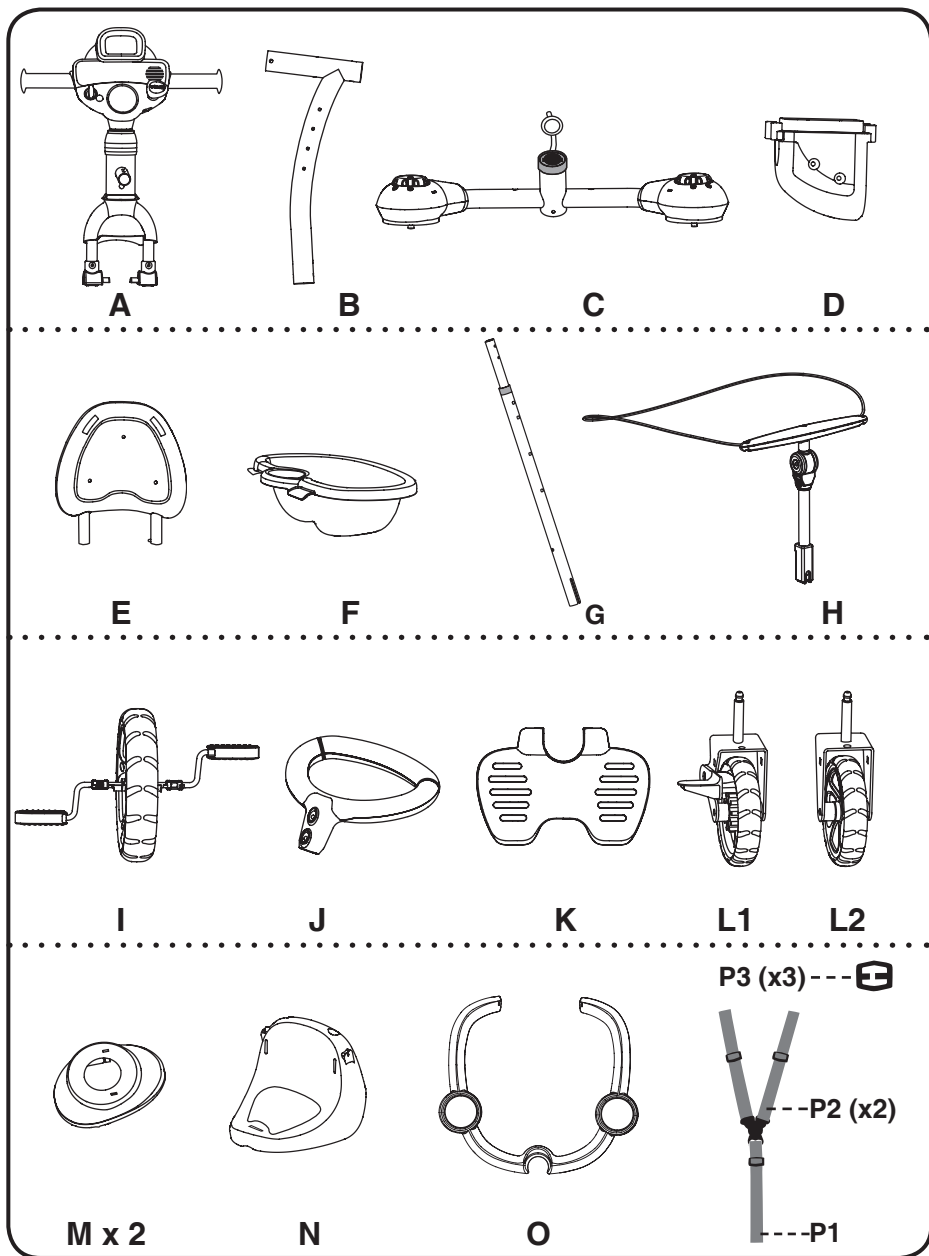

ASSEMBLY AND SET-UP

For additional assistance, watch our assembly video at: vtechkids.com/trike

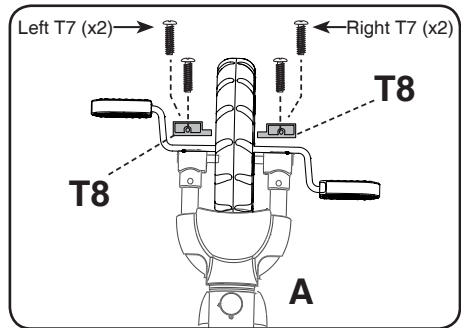
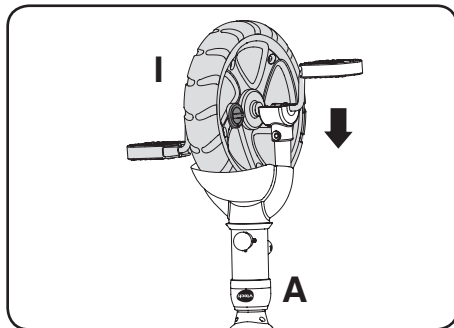
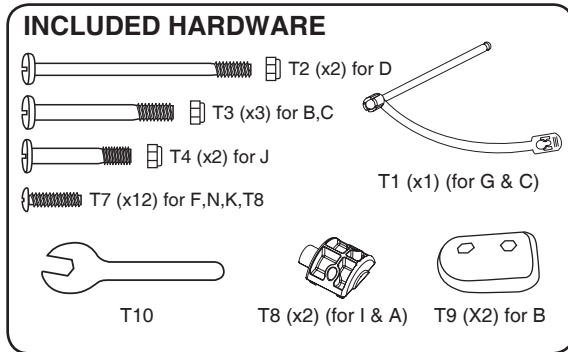

1. Align the front wheel (I) with the slot on the frame (A). The pedal lock should be on the right side of the trike tire.
2. Place the covers (T8) over both sides of the frame (A) and screw them together with 4 T7 screws. Then, set aside.

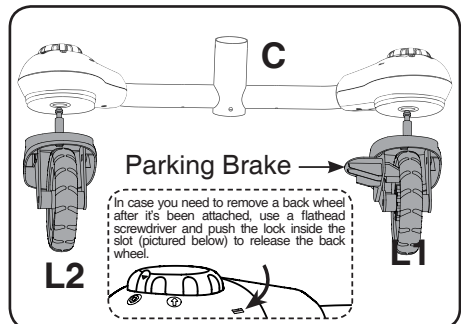
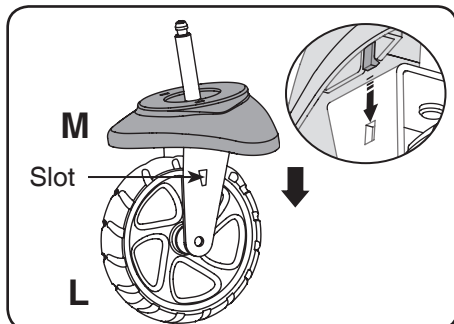

3. Push down the back wheel cover (M) into the slot (L), until it snaps in. Do this twice, once for each wheel.
4. Push the right wheel (L1) and left wheel (L2) into the slots of (C). They will lock in. (The right wheel (L1) has a parking brake but the left wheel does not.)

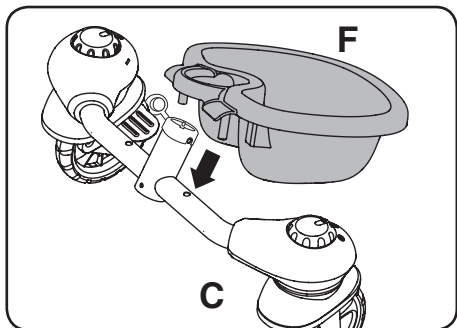

5. Push the storage bin (F) into the frame (C) until it's secure.

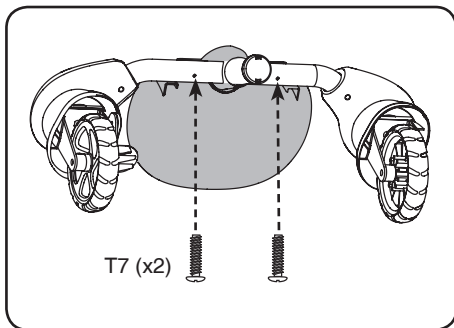

6. Then, screw them together, using 2 T7 screws. Then, set it aside.

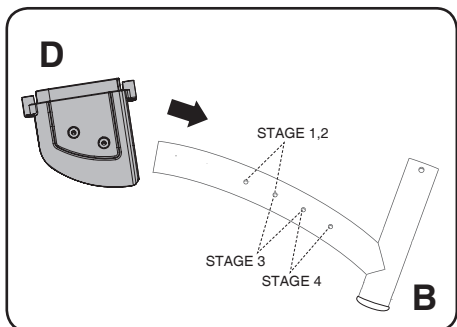

7. Align the opening of (D) with frame (B) and place (D) into Stage 1 of frame (B).

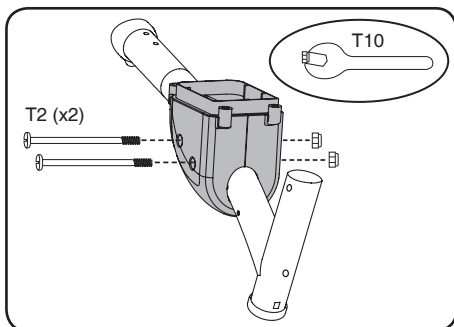

8. Put the nuts (with T10) in place and then screw the T2 screws into the nuts.

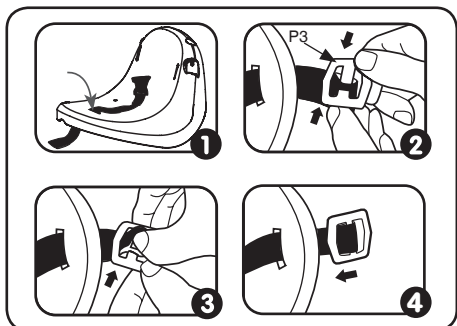

9. Install the seat belt (P1) for seat (N).

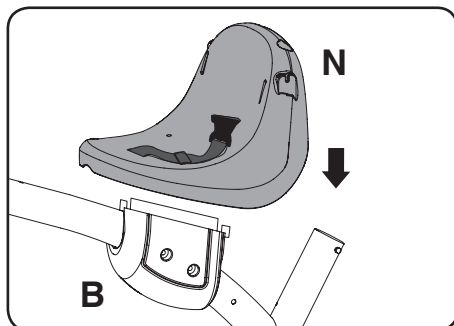

10. Place the seat (N) onto the frame (B).

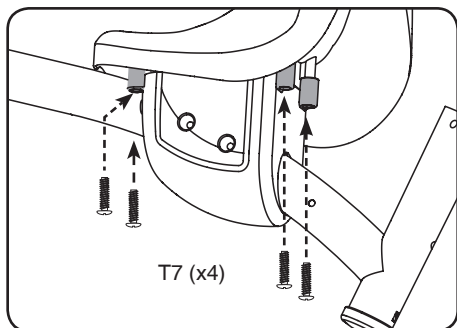

11. Then, screw them together using 4 T7 screws.

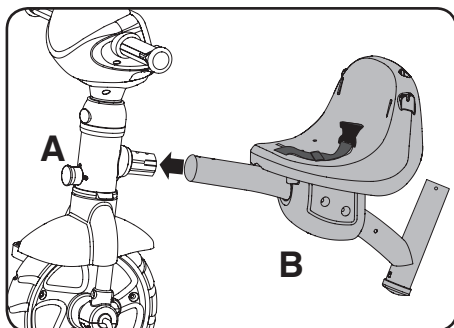

12. Align the opening of frame (B) with frame (A).

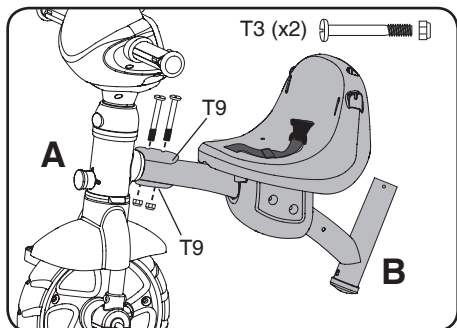

13. Then, fasten T9 to frame (B) with 2 T3 screws and nuts.

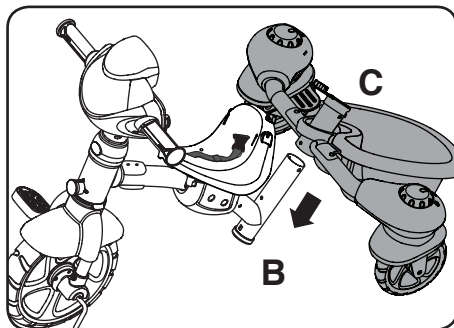

14. Push the frame (C) into the frame (B).

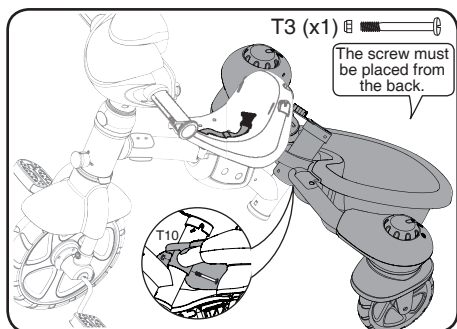

15. Using T10 fasten T3 with screw and nut.

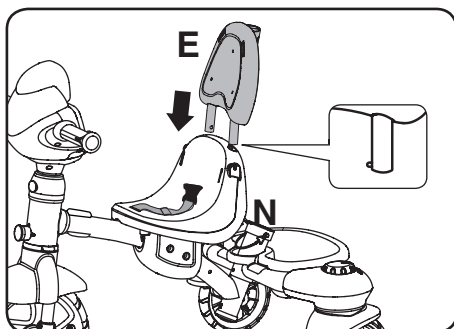

16. Press the push button inward as you push the removable seat back (E) into the seat (N).

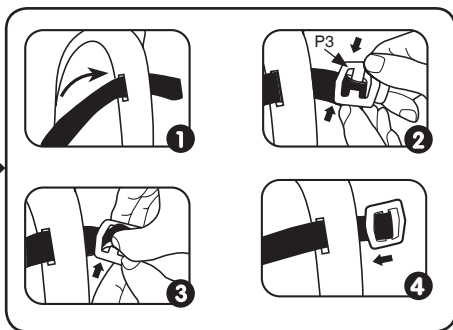
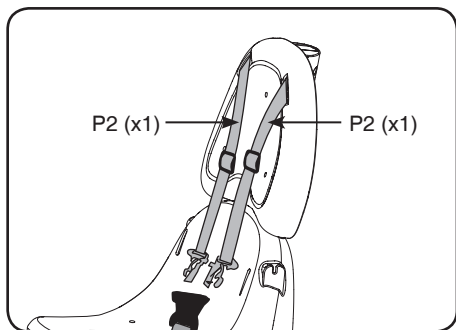

17. Install the seat belts (P2) for the removable seat back.

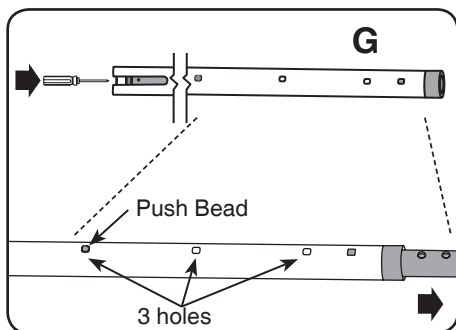

18. Use a screwdriver to push the grey pole inside (G) so that the push bead will glide through the white tube to align with the 3 holes.

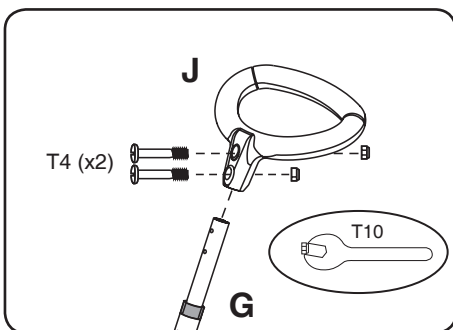

19. Align the handle (J) with the bar (G). Use T10 to fasten with 2 T4 screws and nuts.

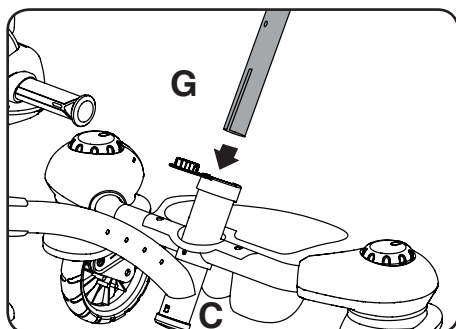

20. Push the push handle (G) down into the hole of frame (C).

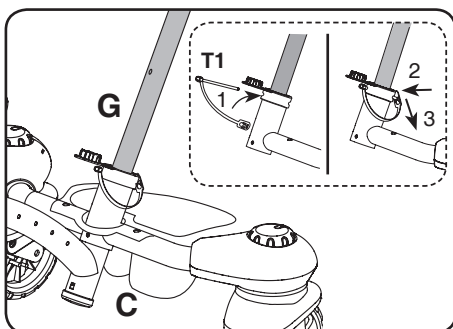

21. Fasten the push handle (G) and frame (C) together by inserting (T1).

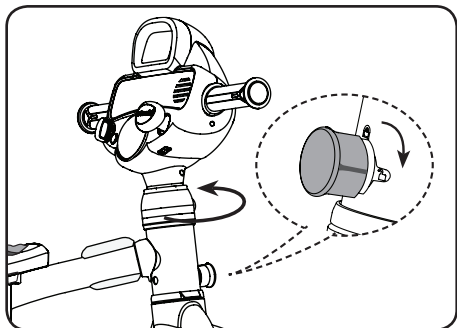

22. To add the footrest to the trike, first, make sure the front steering lock is in the unlock position and turn the handle bars to the trike's left side.

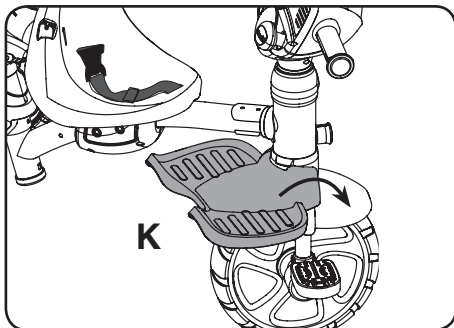

23. Then, put the footrest (**K**) on top of the trike frame. Ensure the footrest fits snug under the ridges on the trike frame.

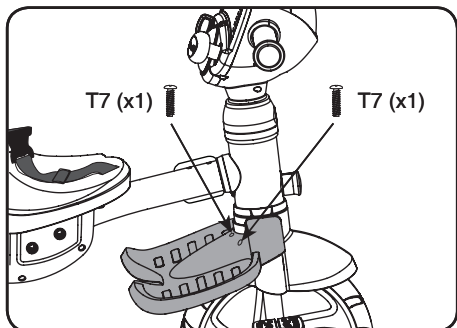

24. Next, turn the handlebars so they are facing forward. Then, fasten with 2 T7 screws.

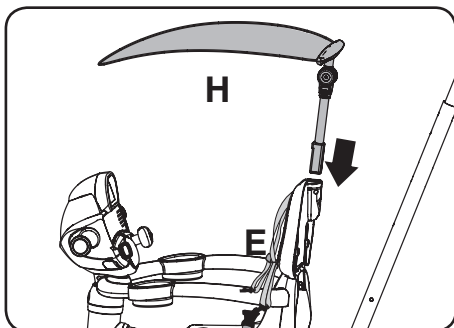

25. Use the push button to insert the canopy (**H**) into the removable seat back (**E**).

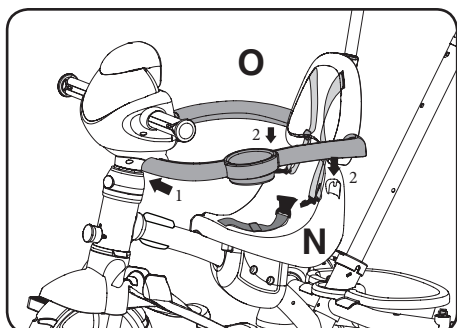

26. Insert the wraparound safety bar (**O**) by snapping it to the front of the trike under the interactive panel and into the grooves on the seat (**N**).

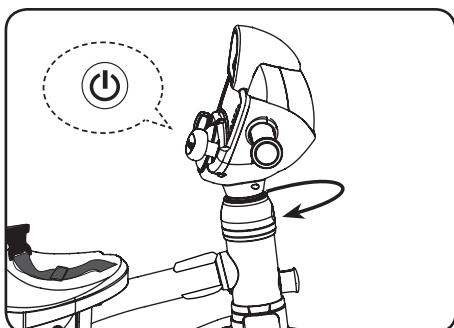

27. To adjust the electronics from In-Store Demo Mode to Normal Mode, please press the **ON/OFF BUTTON** and turn the handlebars towards the right, then the **4-in-1 Stroll & Grow Tek Trike™** is ready to be played.

STAGE 1 - STROLL

9 - 18m

Note:

This is the rear wheel steering control stroller, always adjust the moving direction before pushing forward.

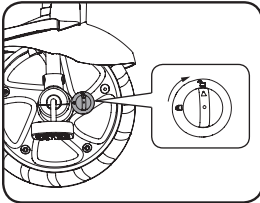
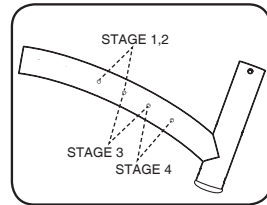
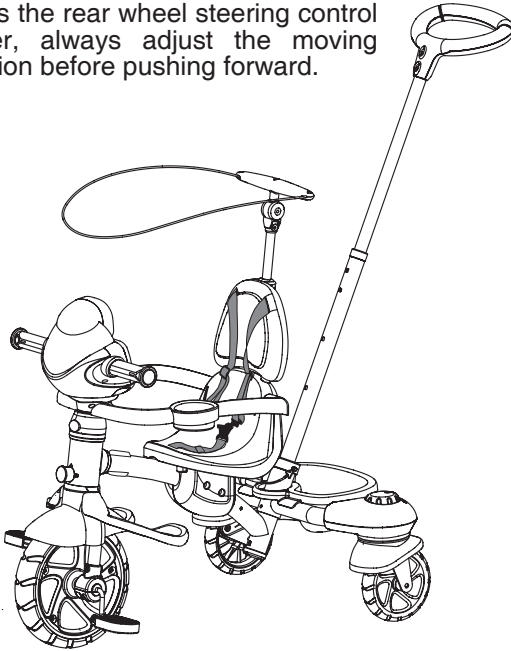

1. Turn the pedal lock clockwise to unlock the pedals. The pedals will not control the movement of the front wheel when the pedals are unlocked.

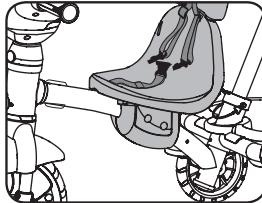

2. Move the seat to the stage 1 position by removing the screws, adjusting the position and then screwing the seat into position.

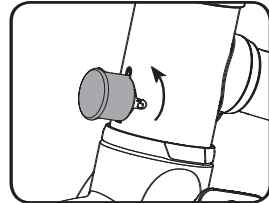

3. Turn the front steering lock counter-clockwise to lock the handlebars.

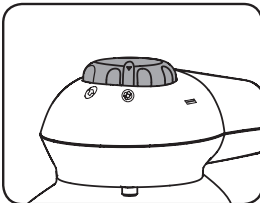

4. Turn the wheel locks to  to unlock the back swivel wheels.

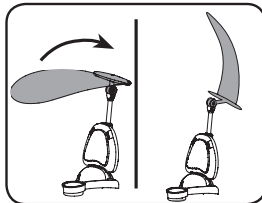

5. Adjust the canopy.

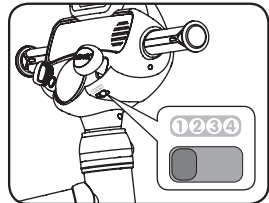

6. Slide the Mode Selector to mode 1 position.

STAGE 2 - TRAIN

18 - 24m

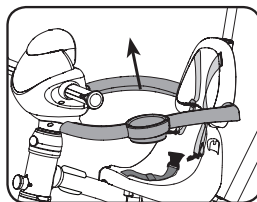
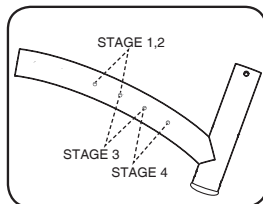
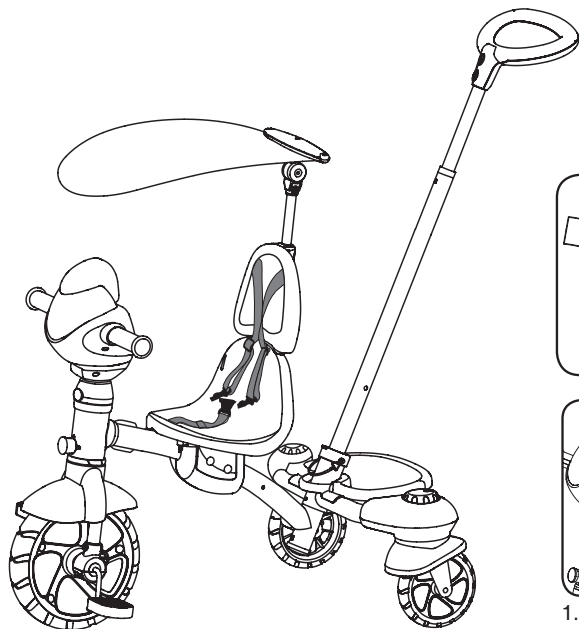

1. Remove the wraparound safety bar.

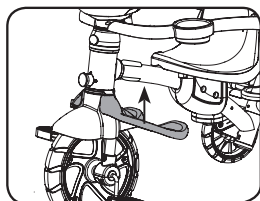

2. Remove the footrest.

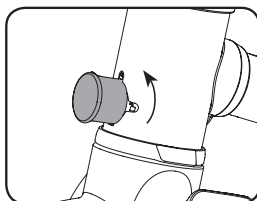

3. Make sure the front steering lock is in the lock position.

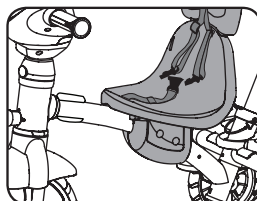

4. Move the seat to the stage 2 position by removing the screws, adjusting the position and then screwing the seat into position.

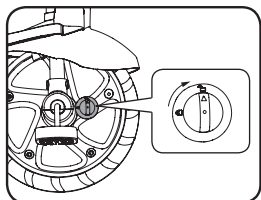

5. Make sure the pedal lock is in the unlock position. The pedals will not control the movement of the front wheel when the pedals are unlocked.

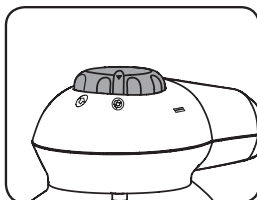

6. Turn the wheel locks to  to unlock the back swivel wheels.

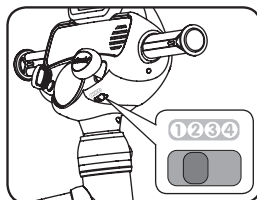

7. Slide the Mode Selector to mode 2 position.

STAGE 3 - RIDE

2 - 4yrs

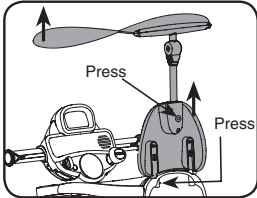
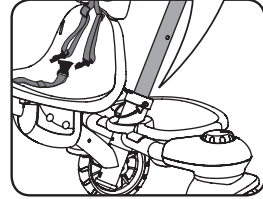
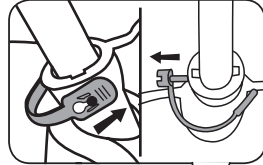
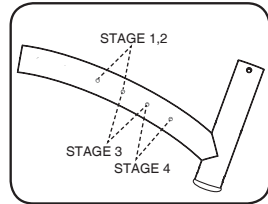
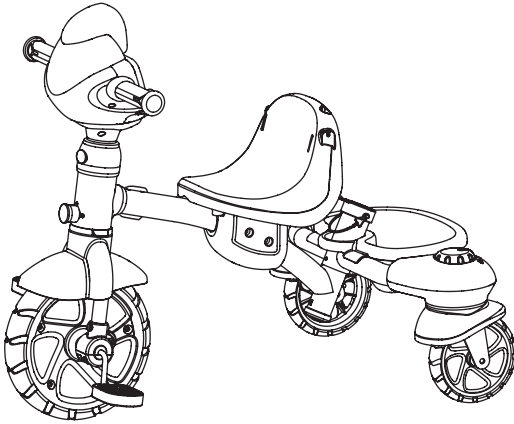

1. Remove the canopy and the removable seat back.

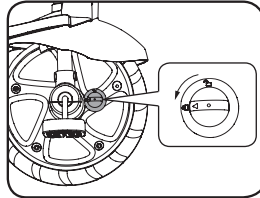

2. Turn the pedal lock counter-clockwise to lock the pedals. The pedals will control the movement of the front wheel when the pedals are locked.

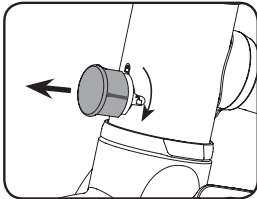

4. Turn the front steering lock clockwise to unlock the handlebars.

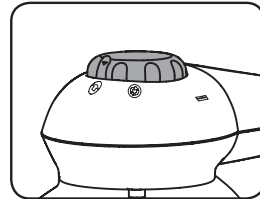

5. Turn the wheel locks to  to lock the back swivel wheels.

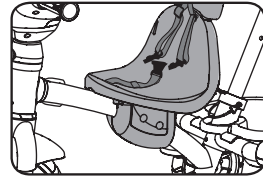

6. Move the seat to the stage 3 position by removing the screws, adjusting the position and then screwing the seat into position.

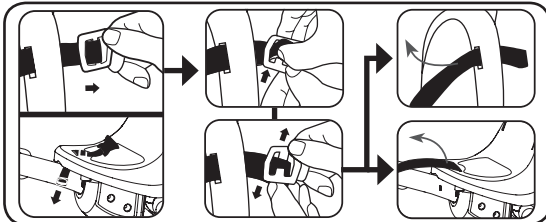

7. Remove the 3-point safety harness.

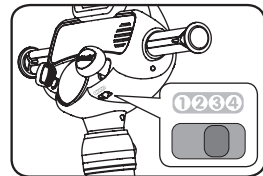

8. Slide the Mode Selector to mode 3 position.

STAGE 4 - DRIFT

4 - 6yrs

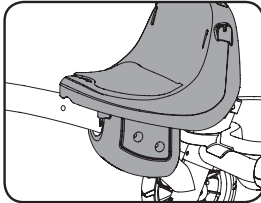
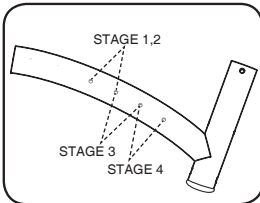
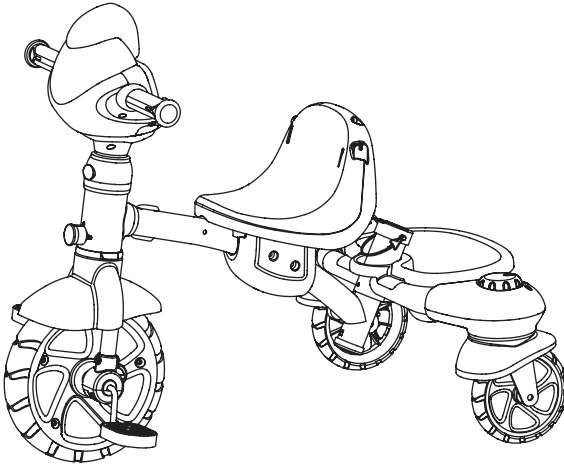

1. Move the seat to the stage 4 position by removing the screws, adjusting the position and then screwing the seat into position.

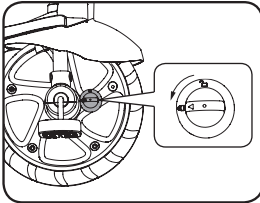

2. Make sure the pedal lock is in the lock position. The pedals will control the movement of the front wheel when the pedals are locked.

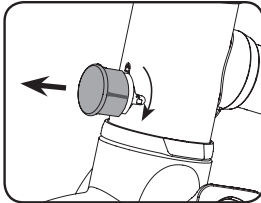

3. Make sure the front steering lock is in the unlocked position.

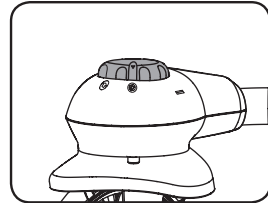

4. Turn the wheel locks to  to unlock the back swivel wheels, and then to have a drifting fun.

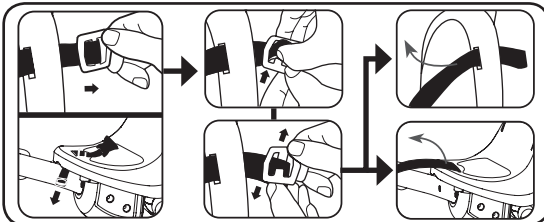

5. Remove the 3-point safety harness.

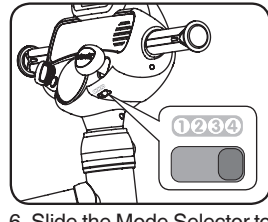

6. Slide the Mode Selector to mode 4 position.

PRODUCT FEATURES

1. ON/OFF BUTTON

To turn the unit **ON**, press the **ON/OFF BUTTON**. Press the **ON/OFF BUTTON** again to turn the unit **OFF**.



2. MODE SELECTOR

Slide the **MODE SELECTOR** to select a mode. In different modes, the response of Role-Play Buttons and Location Buttons will be different.

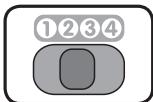

3. HORN BUTTON

Press the **HORN BUTTON** to see it light up and hear fun sound effects.



4. GEAR SHIFT

Move the **GEAR SHIFT** up or down to hear fun sound effects.



5. IGNITION SWITCH

Turn the **IGNITION SWITCH** to hear a fun sound effect.



11. MUSIC STOP BUTTON

Press the **MUSIC STOP BUTTON** to stop playing sing-along songs or melodies.



12. PEDALING

When there is a melody playing while pedaling in mode 2, 3 or 4, the melody will play faster or slower depending on the speed that you're pedaling.

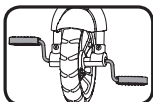

13. HANDLEBARS

Turn the handlebars left or right, and the trike will call out which way you're turning or play a fun sound effect. In addition, the corresponding light will flash and it will play a sound effect.



14. PEDAL LOCK

When the **PEDAL LOCK** is in the unlocked position the pedals will not control the movement of the front wheel. When the **PEDAL LOCK** is in the locked position the pedals will control the movement of the front wheel.

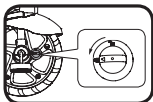

6. FOUR ROLE-PLAY BUTTONS

Press the **ROLE-PLAY BUTTONS** to hear different phrases from each character.



7. LOCATION BUTTONS

Press the **LOCATION BUTTONS** to hear different phrases in different modes.



8. MELODY BUTTON

Press the **MELODY BUTTON** to hear melodies.



9. SING-ALONG SONG BUTTON

Press the **SING-ALONG SONG BUTTON** to hear sing-along songs.



10. VOLUME BUTTON

Press the **VOLUME BUTTON** to adjust the volume.



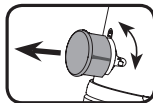

15. FRONT STEERING LOCK

When the **FRONT STEERING LOCK** is in the unlocked position the handlebars will be able to move left and right. When the **FRONT STEERING LOCK** is in the locked position the handlebars will not be able to move left and right.



16. SWIVEL WHEELS

When the back wheel locks are in the  position, the back wheels can turn 360°. When the back wheel locks are in the  position, the back wheels will only go straight.



17. AUTOMATIC SHUT-OFF

To preserve battery life, **4-in-1 Stroll & Grow Tek Trike™** will automatically turn off after several minutes of inactivity. The unit can be turned on again by pressing the **ON/OFF BUTTON**.

The unit will also automatically turn off when the batteries are very low.

MELODY LIST

1. Alouette
2. The Farmer in the Dell
3. She'll Be Coming Round the Mountain
4. Big Rock Candy Mountain
5. BINGO
6. Camptown Races
7. Here We Go Round the Mulberry Bush
8. Row, Row, Row Your Boat
9. Shoo Fly, Don't Bother Me
10. The Wheels on the Bus

SONG LIST

1. Ride, ride, ride your trike
Pedal fast and slow
Forward, backward, left or right
Let's see where we go
2. When you go cruising outside
Remember these rules on your ride
Look both ways for trucks and cars
Keep your hands on the handlebars
Make sure that your shoes are tied
Safety first while you ride!
3. The sun is shining, the air is sweet,
On the pedals I put my feet,
Feel the breeze blowing through my hair
Let's ride our trike everywhere!
4. When you see a friend you know
Stop your trike and say hello

If the problem persists, please call our Consumer Services Department at 1-800-521-2010 in the U.S. or 1-877-352-8697 in Canada, or by going to our website at vtechkids.com and filling out our Contact Us form located under the Customer Support link. A service representative will be happy to help you.

IMPORTANT NOTE:

Creating and developing **VTech**® products is accompanied by a responsibility that we at **VTech**® take very seriously. We make every effort to ensure the accuracy of the information, which forms the value of our products. However, errors sometimes can occur. It is important for you to know that we stand behind our products and encourage you to call our Consumer Services Department at 1-800-521-2010 in the U.S. or 1-877-352-8697 in Canada, or by going to our website at vtechkids.com and filling out our Contact Us form located under the Customer Support link with any problems and/or suggestions that you might have. A service representative will be happy to help you.

Note: This equipment has been tested and found to comply with the limits for a Class B digital device, pursuant to Part 15 of the FCC Rules. These limits are designed to provide reasonable protection against harmful interference in a residential installation. This equipment generates, uses and can radiate radio frequency energy

Ride here and there, go fast and slow
All around the town

5. Let's cruise around and visit different places
We'll play at the park and make silly faces
Let's go to school, to learn to read and write!
At the grocery store, we'll get food for tonight!

CARE & MAINTENANCE

1. Keep the unit clean by wiping it with a slightly damp cloth.
2. Keep the unit out of direct sunlight and away from any direct heat source.
3. Remove the batteries when the unit will not be in use for an extended period of time.
4. Do not drop the unit on hard surfaces and do not expose the unit to moisture or water.

TROUBLESHOOTING

If for some reason the unit stops working or malfunctions, please follow these steps:

1. Please turn the unit **OFF**.
2. Interrupt the power supply by removing the batteries.
3. Let the unit sit for a few minutes, then replace the batteries.
4. Turn the unit **ON**. The unit should now be ready to play again.
5. If the product still does not work, replace with an entire set of new batteries.

and, if not installed and used in accordance with the instructions, may cause harmful interference to radio communications. However, there is no guarantee that interference will not occur in a particular installation. If this equipment does cause harmful interference to radio or television reception, which can be determined by turning the equipment off and on, the user is encouraged to try to correct the interference by one or more of the following measures:

- Reorient or relocate the receiving antenna.
- Increase the separation between the equipment and receiver.
- Connect the equipment into an outlet on a circuit different from that to which the receiver is connected.
- Consult the dealer or an experienced radio/TV technician for help.

THIS DEVICE COMPLIES WITH PART 15 OF THE FCC RULES. OPERATION IS SUBJECT TO THE FOLLOWING TWO CONDITIONS:

(1) THIS DEVICE MAY NOT CAUSE HARMFUL INTERFERENCE, AND (2) THIS DEVICE MUST ACCEPT ANY INTERFERENCE RECEIVED, INCLUDING INTERFERENCE THAT MAY CAUSE UNDESIRABLE OPERATION.

CAN ICES-3 (B)/NMB-3(B)

Caution: Changes or modifications not expressly approved by the party responsible for compliance could void the user's authority to operate the equipment.



PRODUCT WARRANTY

This Warranty is applicable only to the original purchaser, is non-transferable and applies only to "VTech" products or parts. This product is covered by a 3-month Warranty from the original purchase date, under normal use and service, against defective workmanship and materials. This Warranty does not apply to (a) consumable parts, such as batteries; (b) cosmetic damage, including but not limited to scratches and dents; (c) damage caused by use with non-VTech products; (d) damage caused by accident, misuse, unreasonable use, immersion in water, neglect, abuse, battery leakage, or improper installation, improper service, or other external causes; (e) damage caused by operating the product outside the permitted or intended uses described by VTech in the owner's manual; (f) a product or part that has been modified (g) defects caused by normal wear and tear or otherwise due to the normal aging of the product; or (h) if any VTech serial number has been removed or defaced.

Prior to returning a product for any reason, please notify the VTech Consumer Services Department by going to our website at vtechkids.com, filling out our Contact Us form located under the Customer Support link or calling 1-800-521-2010.

If the service representative is unable to resolve the issue, you will be provided instructions on how to return the product and have it replaced under Warranty. Return of the product under Warranty must adhere to the following rules: If VTech believes that there may be a defect in the materials or workmanship of the product and can confirm the purchase date and location of the product, we will at our discretion replace the product with a new unit or product of comparable value. A replacement product or parts assumes the remaining Warranty of the original product or 30 days from the date of replacement, whichever provides longer coverage.

THIS WARRANTY AND THE REMEDIES SET FORTH ABOVE ARE EXCLUSIVE AND IN LIEU OF ALL OTHER WARRANTIES, REMEDIES AND CONDITIONS, WHETHER ORAL, WRITTEN, STATUTORY, EXPRESS OR IMPLIED. IF VTECH CANNOT LAWFULLY DISCLAIM STATUTORY OR IMPLIED WARRANTIES THEN TO THE EXTENT PERMITTED BY LAW, ALL SUCH WARRANTIES SHALL BE LIMITED TO THE DURATION OF THE EXPRESS WARRANTY AND TO THE REPLACEMENT SERVICE AS DETERMINED BY VTECH IN ITS SOLE DISCRETION.

To the extent permitted by law, VTech will not be responsible for direct, special, incidental or consequential damages resulting from any breach of Warranty.

This Warranty is not intended to persons or entities outside the United States of America. Any disputes resulting from this Warranty shall be subject to the final and conclusive determination of VTech.

**Visit our website for more
information about our products,
downloads, resources and more.**

vtechkids.com



TM & © 2017 VTech Holdings Limited.
All rights reserved.
Printed in China.

91-003399-004 (US) (CN)